

# UNIVERSAL WORKSTATION

FOX Model F50-177 240V / 110V

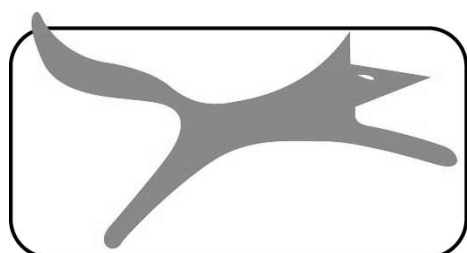

ASSEMBLY AND OPERATING INSTRUCTIONS



# FOX

# Universal Workstation

## FOX MODEL F50-177 240V / 110V

### TABLE OF CONTENTS

- Safety instructions.....Page 3
- Specific safety instructions for workbenches..... Page 5
- Specifications.....Page 7
- Electrical connections..... Page 8
- Earthing instructions..... Page 8
- Environmental protection.....Page 9
- Symbols.....Page 9
- Unpacking.....Page 10
- Assembling your universal workstation.....Page 10
- Parts diagram.....Page 13
- Parts list.....Page 14
- DART Tool Group Guarantee.....Page 15
- Declaration of Conformity.....Page 16



#### ATTENTION :

- Read the instructions for use carefully before using the machine
- This device meets current safety standards for electrical machines.
- Incorrect use may result in injury. Anyone not familiar with the instructions for use should not use the machine. Keep these instructions for use safe.

## SAFETY INSTRUCTIONS

**ALWAYS DISCONNECT THE MACHINE FROM THE POWER SOCKET BEFORE ATTEMPTING ANY MAINTENANCE.**



**Keep a safe working zone for both staff and equipment. NO CHILDREN must be allowed in the working zone under any circumstance.**

The machine must be always disconnected when not in use. Use the on/off switches on the machine. Always disconnect the machine by pulling the plug, do not pull the power cord.

Before using the machine, remove all tools used for setup and keep them away from your working zone. Reconnect the machine. Check that the working zone is clear and that there is plenty room to work with the wood.

Ensure you are in good working position. If the work will produce dust or small pieces, wear safety gear, protective glasses, gloves, a mask and ear defenders. If you have long hair, tie it up. Do not wear watches or bracelets. Wear shoes with good grip and remember to never place your fingers too near the blade.



**Do not use** the machine if you are tired or distracted because you risk injury.



**Do not use this machine** anywhere containing flammable liquids and/or volatile gases.

1. Keep your working area clean. Untidy working zones and busy workbenches invite injuries.
2. **Avoid** a dangerous environment. Do not expose machines to rain and not use them in wet places. Ensure your working zone is well lit. Do not use the machine where there is gas or flammable liquids.
3. **Protect yourself** from electric shocks. Avoid touching earthed surfaces.
4. **Keep** children and visitors well away from the working area.
5. **Tidy** up any tools not in use. When tools are not used, they should be kept in a dry, locked place, out of reach of children.
6. **Do not force** the machine. It will work better when used with the pressure it was designed for.
7. **Use** the correct tools. Do not force a small tool to do the work of a bigger tool. For example, do not use a circular saw to cut branches or logs.

8. **Wear** appropriate clothing. Avoid loose clothing, and remove jewellery which could become caught in moving parts. Non-slip shoes are particularly recommended when working outside. Keep long hair tied up.
9. **Always** wear safety glasses. Also wear a mask if operating the machine creates dust.
10. **Do not** mistreat the power cord. Never use the power cord to pull out the plug. Keep the power cord away from heat, oil and sharp edges.
11. **Do not** bend over the machine. Keep your balance at all times.
12. **Keep** tools in good condition. Clean tools to obtain the best results with them. **Follow instructions** to grease and change accessories. Regularly check the power cord and replace it if damaged. Keep handles dry, clean and free from oil and grease.
13. **Disconnect** the tool when not in use, before the maintenance and while changing accessories such as blades, drills, etc.
14. **Remove** all maintenance tools. Get used to checking that all maintenance tools are removed before using the machine.
15. **Avoid** accidentally starting the machine. Make sure that the switch is in the "OFF" position before connecting the power.
16. When the tool is used outside, use only extension leads designed for outdoor use.
17. **Be observant.** Use common sense when operating machinery. Do not use the tool when tired.
18. **Inspect** parts before use. Before continuing to use the tool, inspect any protective parts) which could be damaged to make sure that they work well. Verify that the moving parts are properly aligned, and are not jammed or broken. Check the assembly and any other conditions which may affect the correct functioning of the machine. Any damaged part or guard must be repaired or replaced by an approved after-sales service centre. Do not use the tool if the switch does not work correctly.
19. **Warning:** the use of any non-recommended accessory can present a health risk.
20. **Have the machine repaired** by a qualified person. This machine is built according to relevant safety requirements. Repairs must only be made by a qualified person using original spare parts, otherwise it may be very dangerous for the user.
21. **Keep these instructions.**

## ADDITIONAL SAFETY RULES FOR WORKBENCHES

### Fixing a power tool to the workbench

- Use in a dry place protected from rain.
- Keep work area clean and well lit.
- Place the workbench in a place where no user or viewer could be in the field of the tool's blade.
- Always ask for help if you need to raise the bench.
- When moving the workbench, keep it folded against your body. Slightly bend your knees so you can lift the set with the your legs and not your back.
- When transporting the workbench in a vehicle, fasten it securely to prevent movement or possible damage.

### Never stand on the bench

- Do not use the bench as a ladder or scaffolding.
- The maximum load weight of the set is 100kg.

### Reduce the risk of injury from unexpected movement of the tool

- Always store your power tool so that the workpiece is positioned relative to the support bars.
- Check that the power tool does not overbalance, slip or does not move forward.
- Place the bench on a flat and level surface.

### Reduce the risk of injury from the workbench

- Keep the work area clean.
- Slippery surfaces and benches invite accidents. The floor should not be slippery due to wax or dust.
- To minimize the risk of burns or other damage caused by fire, never use the workbench and tool near flammable liquids, toxic fumes or gas.

### Provide protection for the eyes, hands, face and ears

- Do not wear loose clothing, gloves, neckties or jewellery (rings, watches).
- Wear non-slip footwear.
- Tie up long hair.
- Roll up your sleeves if they are long.
- Noise levels vary widely. To minimize the risk of possible hearing damage, always wear ear protection.
- Wear a dust mask and eye protection.
- Any tool is in operation generates projections that can cause serious injury.

### During the operation of the power tool :

- Keep all spectators, children and other visitors at a safe distance in relation to the tool.
- Make sure the spectators are well away from the tool and workpiece.

### **Prior to leaving your workbench**

- Turn off the tool.
- Wait until the tool stops.
- Disconnect the tool from the outlet.
- Unplug the set from the wall outlet.

## SPECIFICATIONS

Max. holding weight :	100kg
Support arm length :	650mm
Overall length including extension arms :	3000mm
Dimensions (h x l x d) :	880x1710x670mm
Weight :	26.5kg

## ELECTRICAL CONNECTIONS

### EXTENSION CORDS

Before using any extension cord, make sure that the insulation is not cut or worn. Immediately repair or replace a damaged or frayed cord.



#### **ATTENTION :**

Extension cords must be removed from the work area or located so that they will not get caught in parts, tools or other objects while using the tool.

## EARTHING INSTRUCTIONS

In case of malfunction or short circuit, grounding provides a path of least resistance for electric current to reduce the risk of electric shock. This tool is equipped with an electric cord having an earthing conductor and a grounding plug. The plug must be plugged into a matching outlet that is properly installed and grounded in accordance with all local codes and regulations.

Do not modify the plug provided. If it does not fit into the outlet, have a proper outlet installed by a qualified electrician. Improper connection of the conductor grounded equipment can result in a risk of electric shock. The conductor with insulation is green with or without yellow stripes is the conductor of grounding. If the repair or replacement of the power cord is necessary, do not connect the grounding conductor to a live terminal.

If the earthing instructions are not completely understood, check with a qualified electrician or a person responsible for maintenance, or if there is doubt properly grounding the tool.

If the power cable is damaged, it must be replaced by the manufacturer, after sales service or similarly qualified persons in order to avoid a hazard. Do not operate the tool with a damaged power cable.

This tool is intended for use on an electrical circuit with a wall outlet and earthing pin.



## ENVIRONMENTAL PROTECTION

England		<p>Only for EU countries</p> <p>Do not dispose of electric tools together with household waste material!</p> <p>In observance of European Directive 2002/96/EC on waste electrical and electronic equipment and its implementation in accordance with national law, electric tools that have reached the end of their life must be collected separately and returned to an environmentally compatible recycling facility.</p>
---------	---	---

**The crossed-out wheeled bin means that within the European Union the product must be taken to separate collection at the product end-of-life. This applies to your device but also to any enhancements marked with this symbol. Do not dispose of these products as unsorted municipal waste.**

**The European directive DEEE concerning the environment, states that it is forbidden to dispose of used electric or electronic devices in household waste. They must be taken to a compatible recycling facility.**

**ATTENTION:**

*The manufacturer reserves the right to change specifications without notice.*

*Images are supplied for information purposes only. Actual machine and accessories may differ in appearance.*

## SYMBOLS



Always wear protective goggles when using this machine.



Always wear ear defenders when using the machine.

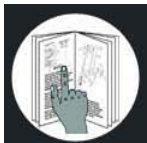

Read and understand the instruction manual before using the machine



Heavy lift. Transporting the machine requires two people.



Always wear a protective mask if the operation is dusty.



Product meets relevant CE standards.

## UNPACKING

Carefully unpack the workstation and all the individual parts contained in the box. Check that no parts are missing or that no parts are damaged.

## ASSEMBLING YOUR UNIVERSAL WORKSTATION

Attach the roller support to the roller support rails and then insert the round-headed roller support screw into the round end of the slot on the top rail, as shown below.



The attachment arms are fixed to the bed by simply pulling the attachment locking handle upwards and clipping the arm onto the bed. The back should be attached first and the front lowered onto the bed and the attachment locking handle released as shown below.

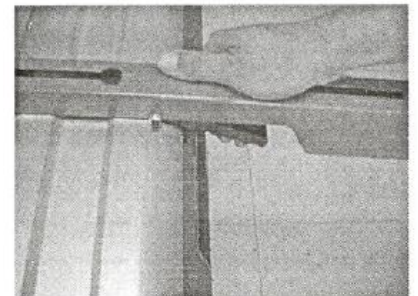
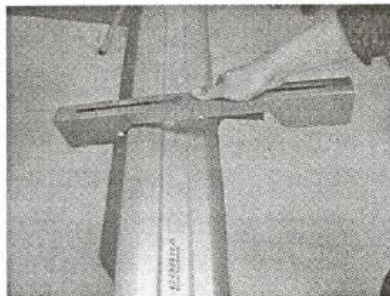
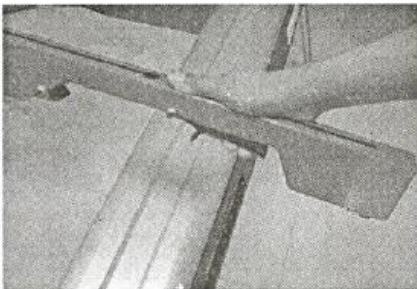

## FIXING A MACHINE TO YOUR WORKSTATION

Various bench-top tools can be used with your universal workstation by simply adding them to the attachment arms as shown below.

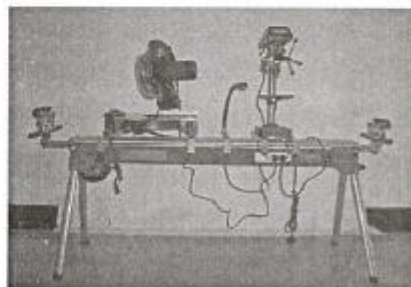
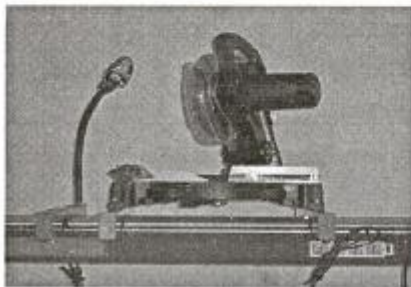
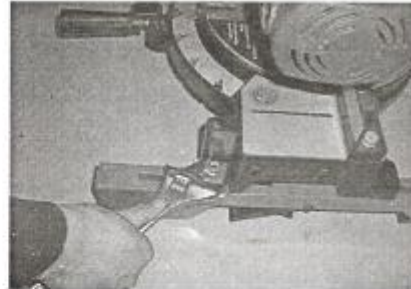
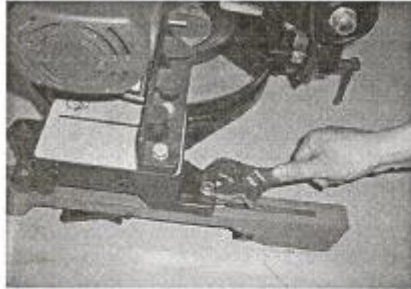

## USING YOUR MACHINES WITH AND WITHOUT THE WORKSTATION

After you have added the attachment arms, your machines can be used separately from the universal workstation as the arms have in-built supports and do not require removal.

## ADJUSTING THE ROLLER SUPPORTS AND STOPS

The roller supports can be adjusted laterally, horizontally and vertically.

The roller support rails can be adjusted laterally depending on the length of material being supported.

Two adjustment locking knobs can adjust the material supports vertically.

The roller supports can be adjusted horizontally by the adjustment locking knobs.

## USE OF ROLLER SUPPORTS

The roller supports can also be used on the central bed for supporting smaller lengths of timber. The roller supports can be removed from the outer support rails.

## **USE OF LOCKING STOPS**

The roller supports have built-in roller stops that can be used when cutting a number of the same lengths of timber. Simply adjust to the required length and flip the stops into the up position.

The roller stops can also be used to clamp large pieces of timber that may require additional work such as sanding.

## **TRANSPORT AND STORAGE**

The universal workstation can be easily folded and transported using the built-in wheel.

## **WORKPIECE VICE**

The universal workstation is supplied with a workpiece vice as standard equipment for use with various hand and power tools.

## **FLEXIBLE WORK LIGHT**

The universal workstation is supplied with a work lamp as standard. It can be moved up and down the bed to the required position, and is flexible so can be directed to where required.

## **POWER CONNECTIONS**

Your universal workstation has three power sockets allowing you to connect multiple tools on the workstation. These connections are not waterproof and should not be used outdoors.

## **STORAGE BOX**

Your workstation has a universal storage box for storing small tools such as pencils and tape measures (not included).

## **ADAPTABLE WORKSTATION**

You can use various tools with your universal workstation, giving you a complete work centre that you can use for the majority of your woodworking operations.

# PARTS DIAGRAM

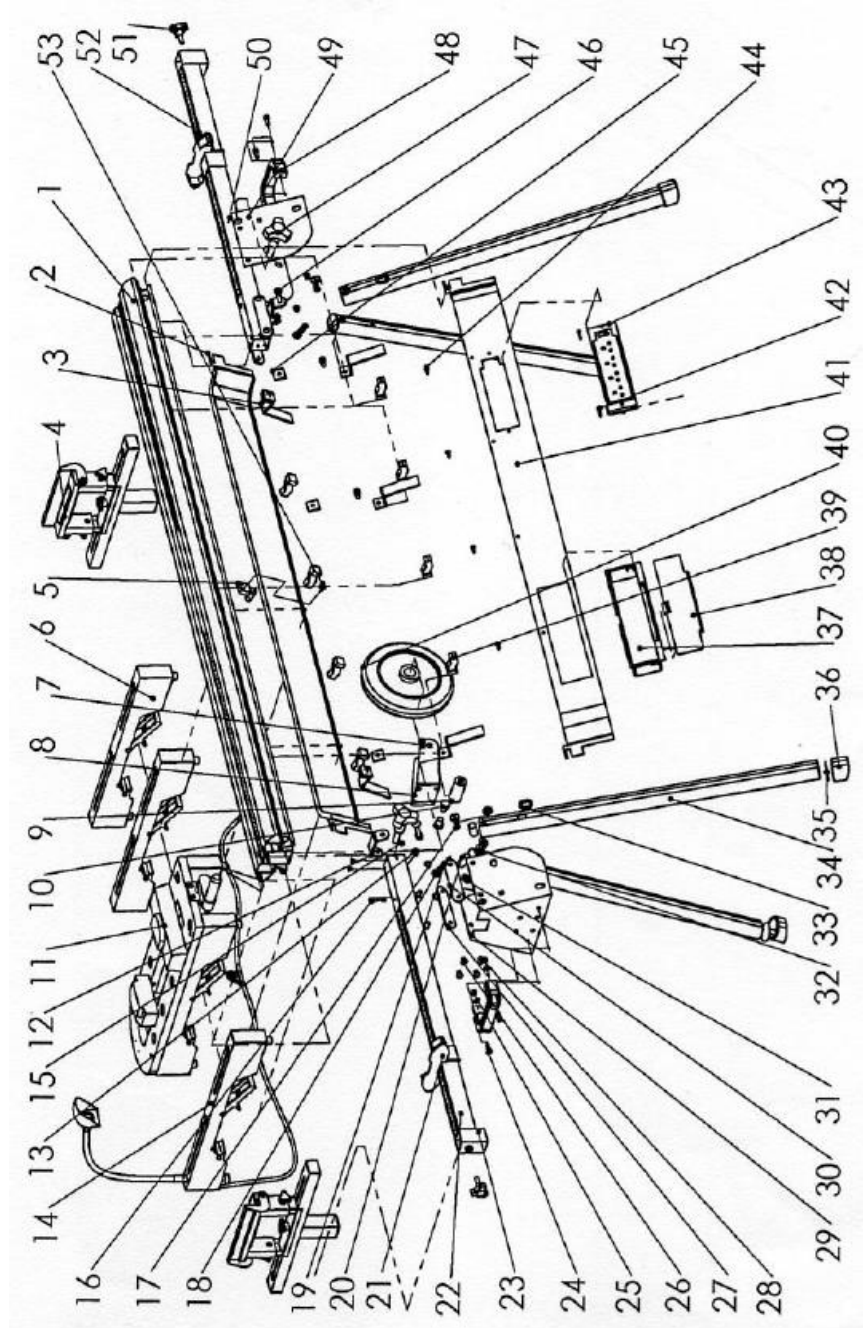

## PARTS LIST

REPERE	REFERENCE	Description
1	50177-1	guide rail
2	50177-2	right fence
3	50177-3	support
4	50177-4	adjustable support
5	50177-5	pothook
6	50177-6	adjustable rail
7	50177-7	hex screw
8	50177-8	wheel support assembly
9	50177-9	wheel spindle
10	50177-10	allen bolt
11	50177-11	quick clamp assembly
12	50177-12	leg support plate
13	50177-13	nylock nut
14	50177-14	light assembly
15	50177-15	plastic washer
16	50177-16	self tapping screw
17	50177-17	circlip
18	50177-18	leg spring
19	50177-19	leg flex pin
20	50177-20	tube
21	50177-21	rail tube cup
22	50177-22	tube
23	50177-23	outer tube
24	50177-24	hex screw
25	50177-25	flat screw
26	50177-26	hex screw
27	50177-27	connected plate
28	50177-28	nylock nut
29	50177-29	left leg base
30	50177-30	left connect plate
31	50177-31	plastic washer
32	50177-32	plastic washer
33	50177-33	plastic washer
34	50177-34	leg
35	50177-35	washer
36	50177-36	leg foot
37	50177-37	plastic box
38	50177-38	box cover
39	50177-39	fence support
40	50177-40	wheel
41	50177-41	left defence
42	50177-42	self tapping screw
43	50177-43	wire box
44	50177-44	Self tapping screw
45	50177-45	screw
46	50177-46	bolt
47	50177-47	tube retaining bolt
48	50177-48	handle
49	50177-49	right connected plate
50	50177-50	right leg base
51	50177-51	bolt
52	50177-52	scale
53	50177-53	self tapping screw

## **DART TOOL GROUP GUARANTEE**

DART TOOL GROUP takes pride in the quality of the power tools it supplies. The component parts of our tools are inspected at various stages of production and each finished tool is subjected to a final check before being packaged for shipment. Because of our confidence in our engineering quality, DART TOOL GROUP agrees to repair or replace any part or parts of FOX Power Tools and accessories which, upon examination, prove to be defective in workmanship or material. The warranty period for the FOX branded products is one year for parts and labour and three years for parts only. The guarantee does not include repair, labour or parts requiring replacement because of misuse, abuse, or normal wear and tear. Repairs made by other than the factory, DART TOOL GROUP service centre or authorised FOX service dealers relieves DART TOOL GROUP of further liability under this guarantee. THIS GUARANTEE IS MADE EXPRESSLY IN PLACE OF ALL OTHER GUARANTEES OR WARRANTIES, EXPRESSED OR IMPLIED, WITH RESPECT TO QUALITY, MERCHANTABILITY, OR FITNESS FOR A PARTICULAR PURPOSE.



CE DECLARATION OF CONFORMITY OF THE MANUFACTURER

SERRACON

WHEATFIELD ROAD

DUNNIKIER BUSINESS PARK

KIRKCALDY, UK, KY1 3PD

Tel. +44 (0) 1592 652946 Fax: +44 (0) 1592 654854

Declares that the: UNIVERSAL WORKSTATION (F50-177)

is in compliance with the regulations included in the Directives: CEE 2006/42-2004/108-2006/95

Person authorized to create the technical file: **Robert Paterson**

---

CE

06.05.2011

---

The Director

*Robert Paterson*